



LS Series Aquatic Sand Filter

AQUATIC FILTERS

KEY FEATURES

- Ideal for Sensitive Aquatic Environments or Salt Water Systems
- All Wetted Hardware Manufactured from 316 Stainless Steel
- Corrosion Resistant Thermoplastic Housing and Base
- Durable Flanged Inspection Cover
- Integral Top Diffuser
- Efficient, Multilateral Underdrain Assembly
- Integral Molded Drain Plug

OPTIONS

- LS Aquatic 6-Way Multiport Valve

TECHNICAL INFORMATION

EXPLODED VIEW

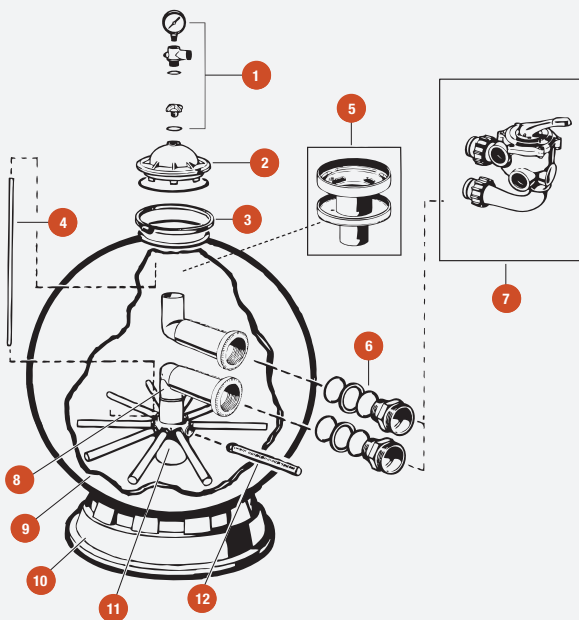

SELECTION CHART

SIZE	MATERIAL	END CONNECTIONS	PIPING SIZES	SEALS	FLOW RATE	PRESSURE RATING
31"	HDPE	NPT	2" (DN50)	EPDM	99GPM	50PSI @ 70F Non-Shock
36"					130GPM	

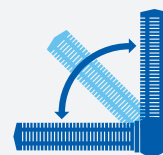

PATENTED SERVICE-EASE DESIGN

Unique folding ball joint design allows lateral assembly to be easily accessed for simple servicing.

LS Series Aquatic Sand Filters

AQUATIC FILTER

TECHNICAL INFORMATION, CONTINUED

PARTS LIST

- | | |
|--|------------------------------|
| 1. Relief Valve/Gauge Adapter Assembly | 9. Filter Tank |
| 2. Top Closure Dome | 10. Filter Support Stand |
| 3. Flange Clamp | 11. Folding Lateral Assembly |
| 4. Air Tube | 12. Lateral |
| 5. Top Diffuser Assembly | |
| 6. Bulkhead Fitting Assembly | |
| 7. Vari-Flow Valve Assembly | |
| 8. Elbow Assembly | |

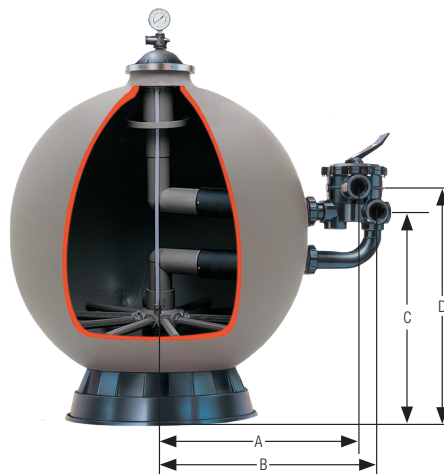

DIMENSIONS

PART NUMBER	HEIGHT in / mm	WIDTH in / mm	A in / mm	B in / mm	C in / mm	D in / mm
LS311SX	39 / 990	31 / 787	21.03 / 534	23.59 / 599	21.62 / 549	24.62 / 625
LS360SX	46 / 1169	36 / 914	23.80 / 604	26.36 / 669	25.45 / 646	28.45 / 723

Dimensions are approximate. Please check dimensions before installing.

FILTER PERFORMANCE DATA

PART NUMBER	EFFECTIVE FILTRATION RATE ft / m	DESIGN FLOW RATE gpm / lpm	MAXIMUM WORKING PRESSURE psi / bar	TURNOVER RATE gph / kl	TURNOVER		SAND REQUIRED lbs / kg
					8 HOURS gal / kl	10 HOURS gal / kl	
LS311SX	4.95 / 0.46	99 / 375	50 / 3.45	5,940 / 23	47,520 / 180	59,400 / 225	350 / 159
LS360SX	6.50 / 0.60	130 / 492	50 / 6.45	7,800 / 29	62,000 / 236	78,000 / 295	700 / 318

Based upon 20 GPM per ft.² (815 LPM per m²).

FILTER SPECIFICATIONS

PART	SPECIFICATION
Filter Type	High-rate sand: No. 2 silica sand (0.45 mm - 0.55 mm)
Filter Tank	Spherical, Molded High Density Polyethylene
Underdrain	360° self-cleaning slotted laterals, precision installed in ball-joint assembly
Control Valve	LS Aquatic 6-Way Multiport Valve
Support Base	Injection-Molded ABS
Performance Range	99 to 130 GPM (375 to 492 LPM)
Port Size	2" NPT
Pressure Rating	50 PSI @ 70°F Non-Shock
Dimensions	LS311SX - 31" W x 38 5 / 8" H (787 mm x 981 mm) LS360SX - 36" W x 46" H (914 mm x 1168 mm)



Hayward is a registered trademark
of Hayward Industries, Inc.
© 2018 Hayward Industries, Inc.

USA: 1.888.429.4635 • Fax: 1.888.778.8410 • One Hayward Industrial Drive • Clemmons, NC 27012 • Email: hfcsales@hayward.com
Canada: 1.888.238.7665 • Fax: 1.905.829.3636 • 2880 Plymouth Drive • Oakville, ON L6H 5R4 • Email: hflowcanada@hayward.com
Visit us at: haywardflowcontrol.com